



5.

Mounting Accessories

All pipes are subject to thermal expansion or contraction. It is therefore essential that the designer or installer selects the correct support system to accommodate such movement.

The comprehensive range of Flamco pipe support systems and components provide a solution for all conditions and pipe materials including fixed-point installations.

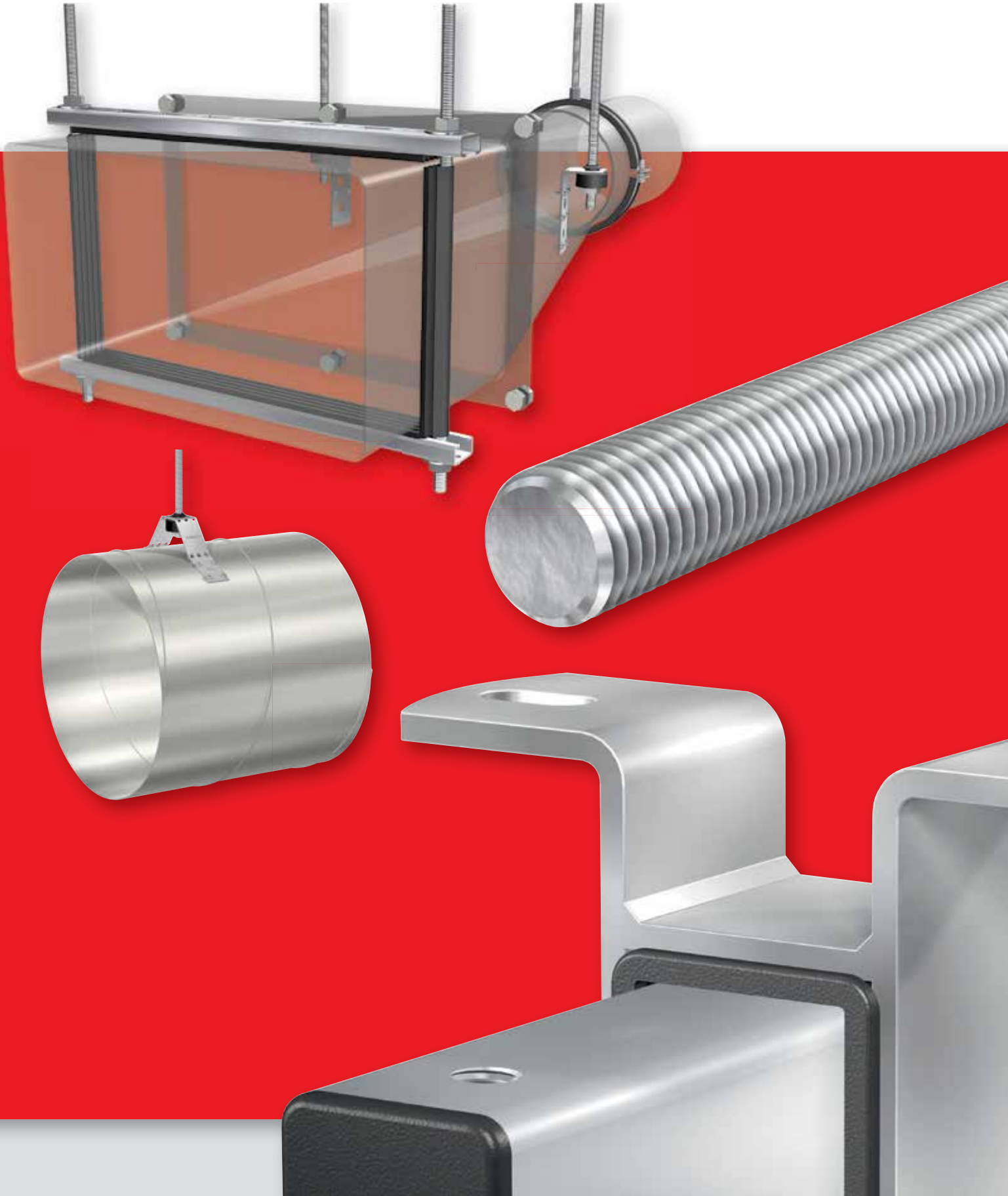

Everything you need for optimal installation

Proper pipe support demands that there is a wide range of quality fixtures and fittings available. Because you'll need more than just a clip and a pipe, Flamco offers an extensive range of mounting accessories.

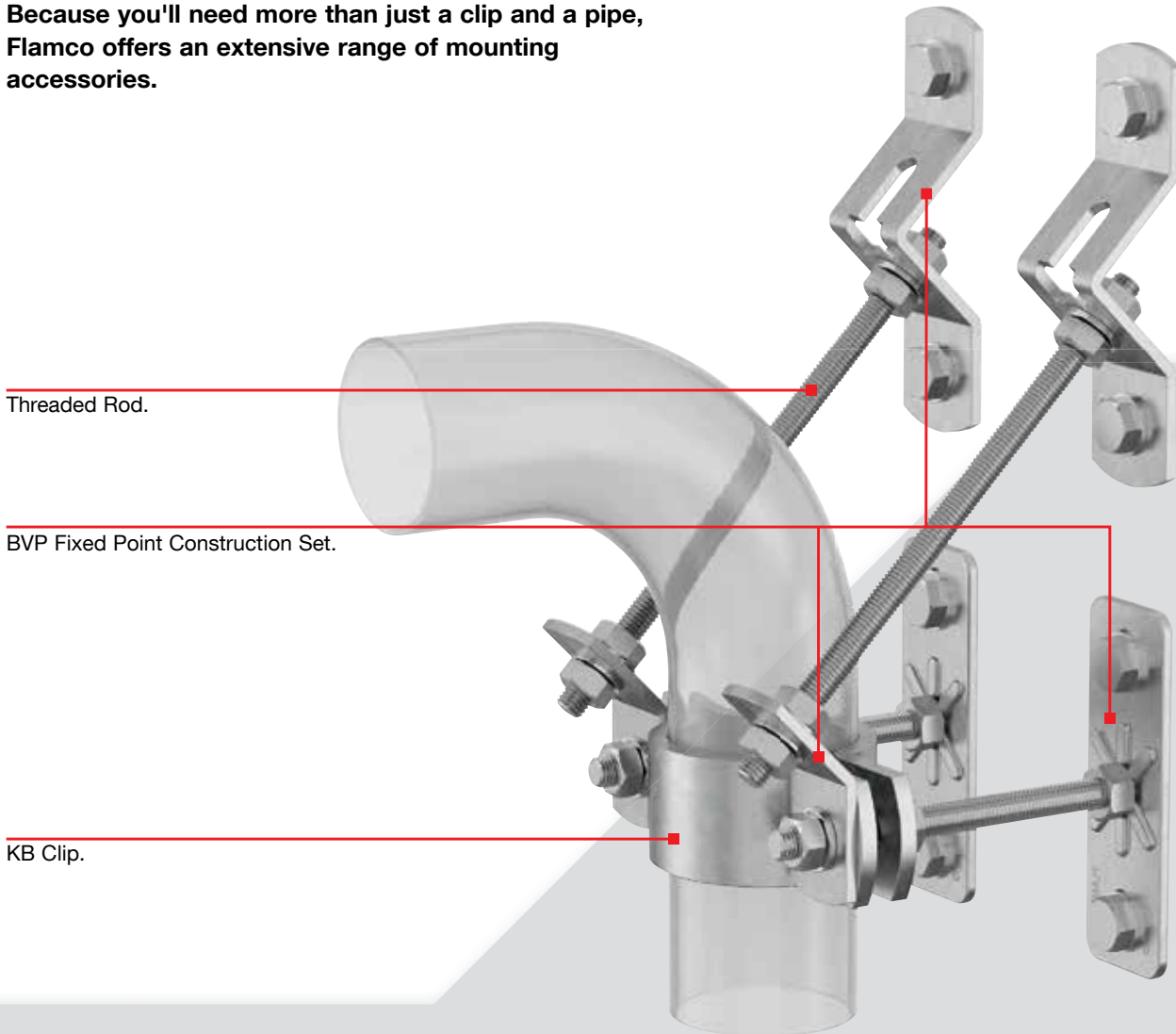

Threaded Rod.

BVP Fixed Point Construction Set.

KB Clip.



PROFILE CLIPS AND CLAMPS



EXPANSION UNITS



CONNECTORS AND ADAPTERS

Table of threaded products for wall mounting

Ø	Threaded rods (ISO 965-2, Quality 4.8)						Threaded tubes with int. thread (ISO 228)	Threaded tubes with ext. thread (ISO 228)		
	M 6	M 8	M 10	M 12	M 16	M 20	½"	¾"	1"	
I _x [mm ⁴]	25	86	218	462	1655	4033	4189	3429	8752	22151
W _x [mm ³]	11	27	53	94	244	476	351912	368	1293	1463
M _b [Nmm]	1705	4254	8535	15012	39078	76224	62940	58902	206832	234011
L [mm]	Max. load on end of rod/pipe L [N]									
50	34	85	171	300	782	1524	1259	1178	4137	4680
75	19	57	114	200	521	1016	839	785	2758	3120
100	11	36	85	150	391	762	629	589	2068	2340
125	-	23	59	120	313	610	504	471	1655	1872
150	-	16	41	86	261	508	420	393	1379	1560
175	-	12	30	63	223	436	360	337	1182	1337
200	-	-	23	49	174	381	315	295	919	1170
225	-	-	18	38	137	335	280	262	726	1040
250	-	-	15	31	111	271	252	230	588	936
300	-	-	10	22	77	188	196	160	408	780
350	-	-	-	16	57	138	144	118	300	669
400	-	-	-	12	43	106	110	90	230	581
450	-	-	-	10	34	84	87	71	182	459
500	-	-	-	-	28	68	70	58	147	372
600	-	-	-	-	19	47	49	40	102	258
700	-	-	-	-	14	35	36	29	75	190
800	-	-	-	-	11	26	27	23	57	145
900	-	-	-	-	-	21	22	18	45	115
1000	-	-	-	-	-	17	18	14	37	93

f =	$\frac{F \times L^3}{3 \times E \times I}$	mm	Deflection
f _{max} =	$\frac{L}{150}$	mm	Permissible deflection
σ =	$\frac{F \times L}{W}$	N/mm ²	Tension
σ _{max} =	160	N/mm ²	Permissible bending stress
I _x =	$\frac{\pi \times d^4}{64}$	mm ⁴	Moment of inertia
W _x =	$\frac{\pi \times d^3}{32}$	mm ³	Section modulus
E =	21,000	N/mm ²	Tensile modulus
M _b =	25	Nmm	Bending moment

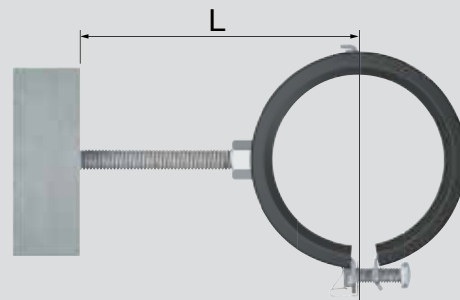

The lowest value is normative.



THREADED RODS AND TUBES



BACKPLATES



ANCHORS



THREADED RODS AND STUDS

D Threaded Ends

For all fixing and constructions requiring threaded rod.

- Electrolytically zinc-plated.
- As per ISO 965-2.
- Material S235JR EN 10250/2.

Type	Connection	L. [mm]		Order Code
D 8 x 25	M 8	25	100	70750
D 8 x 40	M 8	40	100	70751
D 8 x 70	M 8	70	100	70752
D 8 x 80	M 8	80	100	70753
D 8 x 100	M 8	100	100	70754
D 8 x 150	M 8	150	100	70760
D 8 x 200	M 8	200	100	70761
D 10 x 25	M 10	25	100	70755
D 10 x 40	M 10	40	100	70756
D 10 x 60	M 10	60	100	70757
D 10 x 80	M 10	80	100	70758
D 10 x 100	M 10	100	100	70759
D 10 x 120	M 10	120	100	70762
D 10 x 150	M 10	150	100	70763
D 10 x 200	M 10	200	100	70764



Threaded Tube Female

Female thread.

Type	Connection	L. [mm]		Order Code
Threaded pipe 1/2" x 1 m	G 1/2" F	1000	5	51615



Threaded Tube Male

Male thread.

Type	Size	L. [mm]		Order Code
Threaded pipe 1/2" x 2 m	G 1/2" M	2000	10	51611
Threaded pipe 3/4" x 2 m	G 3/4" M	2000	5	51612
Threaded pipe 1" x 2 m	G 1" M	2000	5	51613



D Threaded Rods

For all fixing and constructions requiring threaded rod.

- Electrolytically zinc-plated, except order code 70095.
- Steel grade 4.8.
- Material S235JR EN 10250/2.
- In accordance with DIN 976-1.

Type	Connection	Length [m]	Max. working load [N]		Order Code
D 6	M 6	1	2500	100	70011
D 8	M 8	1	4500	50	70012
D 8	M 8	3	4500	50	70042
D 8	M 8	2	4500	50	70032
D 10	M 10	1	7000	25	70013
D 10 copper	M 10	1	7000	1 m.	70095
D 10	M 10	2	7000	25	70033
D 10	M 10	3	7000	25	70043
D 12	M 12	1	10000	20	70014
D 12	M 12	2	10000	20	70034
D 12	M 12	3	10000	20	70044
D 16	M 16	1	18000	10	70015
D 16	M 16	2	18000	10	70035
D 20	M 20	1	25000	5	70016



ANCHORS, PLUGS AND SCREWS

AS Segment Anchor

- Electrolytically zinc-plated.
- AS 8 x 75/90/115: with S 8s 8 x 28 washer.



Type	Connection	Dimensions		Drill diameter [mm]	Drill depth [mm]	Shear load * [kN]	Pull-out load * [kN]		Order Code
		L [mm]	Spanner size (SW)						
AS 8 x 50 **	M 8	50	13	8	40	4.95	3.57	100	82030
AS 8 x 75	M 8	75	13	8	65	5.31	4.76	100	82035
AS 8 x 90	M 8	90	13	8	65	5.31	4.76	100	82036
AS 8 x 115	M 8	115	13	8	65	5.31	4.76	100	82037

* In non-cracked concrete C20/25, -5 °C - 50 °C.
 ** Without ETA approval.



AP Push-in Anchor

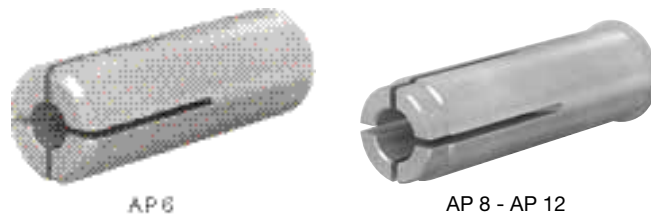

Type	Connection	Drill diameter [mm]	Drill depth [mm]	Rec. tensile load * [kN]	Approval			Order Code
					FM	VdS		
AP 6	M 6	8	-	-	-	-	100	82000
AP 8	M 8	10	33	2.4	-	✓	100	82001
AP 10	M 10	12	44	3.6	✓	✓	100	82002
AP 12	M 12	15	54	6.35	✓	✓	50	82003

* In non-cracked concrete C20/25 - C50/60.



APP Pin

For AP push-in anchor.

Type	Connection		Order Code
APP 6	M 6	100	82005
APP 8	M 8	100	82006
APP 10	M 10	100	82007
APP 12	M 12	100	82008





AB Brass Anchor

For indoor and outdoor applications.

- Corrosion resistant.
- Can be applied without using a hammering pin. The anchor expands when screwing in bolts / threaded rod.
- With metric internal thread.



Type	Connection		Order Code
AB 6	M 6	100	82010
AB 8	M 8	100	82011
AB 10	M 10	100	82012

AT Tipping Dowel

Special attachment for false ceilings, hollow walls and corrugated sheets.

- VdS approved.
- With large washer.

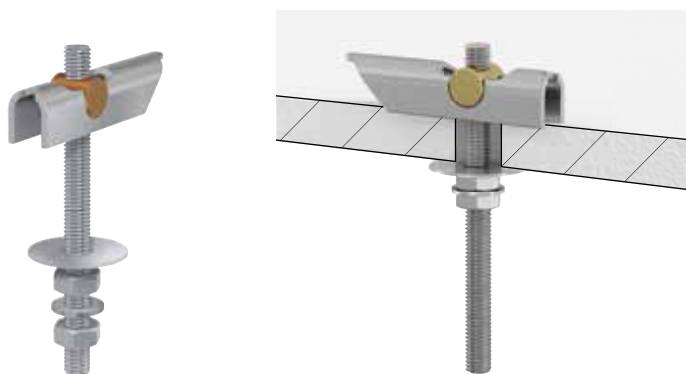

Type	Connection	L. [mm]	Drill diameter [mm]		Order Code
AT 8 x 100	M 8	100	20	50	82025
AT 10 x 100	M 10	100	25	25	82026



MOUNTING TOOLS

For the easy tightening of wood screw studs, coach screws and studs.

Drive Tool

- Electrolytically zinc-plated.
- One assembly spanner with four different thread sizes.
- Rotating lever.



Type	Connection		Order Code
Drive tool	M 6 / M 8 / M 10 / M 12	50	71400

Flamco threaded end bit set

Threaded end bit set supplied in a soft case.

Type	Connection		Order Code
Flamco threaded end bit set	M 6 / M 8 / M 10 / M 12	20	71401



NOISE-SUPPRESSION STRIPS

Suitable for Flamco rail and threaded rods.

- Rubber: EPDM.
- At normal frequency and pressure range, noise suppression 20 dB(A).
- Suitable for temperatures -40 °C to +120 °C.
- Electrical values: specific resistance: $2 \times 10^9 \Omega\text{cm}^2$.
- Surface resistance: $2 \times 10^9 \Omega$.
- Breaking elongation: 400%.
- Tensile strength: 500 N/cm².
- Impact resilience: 35%.

SR 4 Strips

Type	Dimensions			Suitable for	Icon	Order Code
	B [mm]	H [mm]	D [mm]			
SR 4	30	16.5	7	Threaded rod M 8 / Rail R 1 - R 8		71114

CONNECTORS

AD Adapters

For a rigid construction with a BS universal clip.

- Electrolytically zinc-plated.
- Can be used in conjunction with a GP 1/2" backplate.

Type	Connection		Dimensions		Icon	Order Code
	D1	D2	B [mm]	L [mm]		
AD 8 x 1/2	M 8 M	1/2" F	26	31		70914
AD 10 x 1/2	M 10 M	1/2" F	26	33		70915
AD 1/2 x 3/4	1/2" F	3/4" F	31.5	26		70922



KSM Connectors

For connecting BK pipe hangers under each other, two threaded rods, or BS universal clips.

- Electrolytically zinc-plated.
- As per DIN 13, part 12, rolled thread.

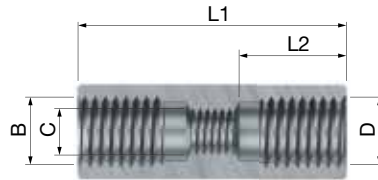

KSM 1

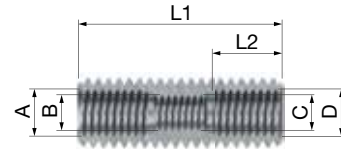

KSM 2



KSM 3

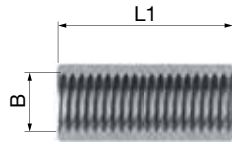

KSM 4, 6, 7, 9

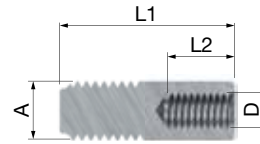

KSM 10

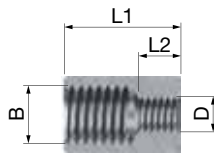

KSM 11

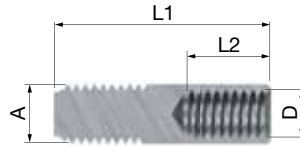

KSM 12

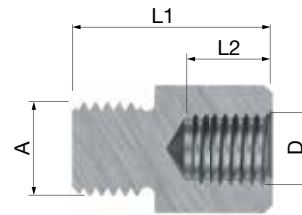

KSM 13, 14, 15, 16, 17, 18, 19

Type	Connection				Dimensions		Shape		Order Code
	A (M)	B (F)	C (F)	D (F)	L 1 [mm]	L 2 [mm]			
KSM 1	-	M 12	M 8	M 12	46	15	round	25	70901
KSM 2	M 12	M 8	M 6	M 8	35	10	round	25	70902
KSM 3	M 8	-	-	M 6	42	8	round	25	70903
KSM 4	-	M 10	-	-	30	-	hex.	25	70904
KSM 6	-	M 6	-	-	20	-	hex.	25	70906
KSM 7	-	M 8	-	-	25	-	hex.	25	70907
KSM 9	-	M 12	-	-	30	-	hex.	25	70909
KSM 10	M 10	-	-	M 6	30	10	round	500	70910
KSM 11	-	M 10	-	M 6	20	10	round	25	70911
KSM 13	M 8	-	-	M 10	22	7	hex.	25	70913
KSM 14	M 10	-	-	M 12	25	7	hex.	25	70917
KSM 15	M 12	-	-	M 10	23	7	hex.	25	70918
KSM 16	M 8	-	-	M 12	23	7	hex.	25	70916
KSM 18	M 16	-	-	M 12	34	12	hex.	25	70920
KSM 19	M 10	-	-	M 8	21,5	8	hex.	25	70921

Threaded couplings

- Electrolytically zinc-plated.

Type	Connection thread	L. [mm]		Order Code
Threaded coupling M 8 x 25	M 8	25	100	61690
Threaded coupling M 8 x 35	M 8	35	100	61692
Threaded coupling M 6 x 25	M 6	25	100	61680
Threaded coupling M 6 x 30	M 6	30	100	61682
Threaded coupling M 10 x 25	M 10	25	100	61700
Threaded coupling M 10 x 35	M 10	35	100	61702
Threaded coupling M 12 x 25	M 12	25	100	61686



Sleeve

Type	Connection		Order Code
Sleeve 1/2	1/2" F	100	52810



Reducing Connector





Type	Connection			Order Code
	From	To		
3/4 - 1/2 adapter	3/4"	1/2"	100	52417
1/2 - M 10 adapter	1/2"	M 10	100	52418
3/8 - M 10 adapter	3/8"	M 10	100	52419

PV Parallel Connectors

For the easy and fast connection of two threaded rods of the same diameter.

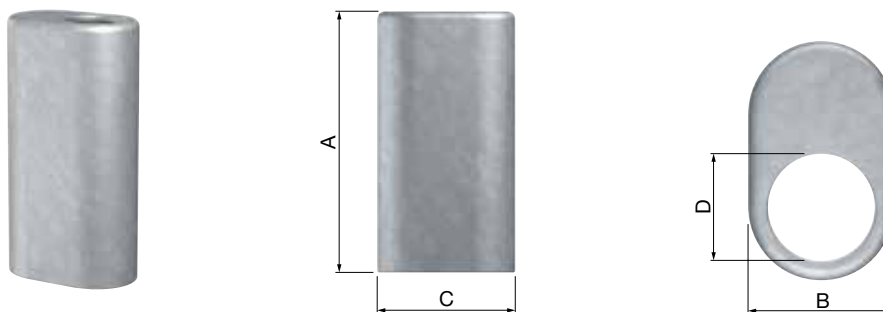
- Zamac.
- Vertical adjustment possible.
- Safety margin for min. breaking load (V) = 3.



Type	Connection	Dimensions				Max. working load [N]		Order Code
		A [mm]	B [mm]	C [mm]	D [mm]			
PV 8	M 8	34	11	18.5	8	2800	50	70951
PV 10	M 10	35	14	23	10	2800	50	70952

K Ball Hangers

For a flexible and vertically adjustable suspension.

- Electrolytically zinc-plated.
- Maximum swing of the ball element: $2 \times 20^\circ$.
- Vertically adjustable by turning lowest part of the ball hanger after fitting the pipe.
- Inspection hole for checking length of rod inside the hanger.
- Safety margin for min. breaking load (V) = 3.

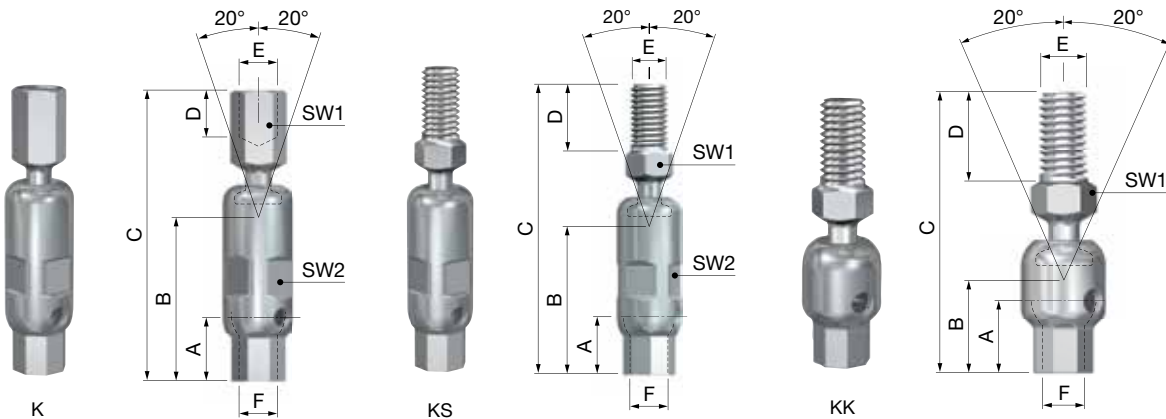

Type	Connection		Dimensions						Max. working load [N]		Order Code
	E	F	C [mm]	A [mm]	B [mm]	D [mm]	SW1 [mm]	SW2 [mm]			
K 6 x 6	M 6 F	M 6 F	58	8	30	8	10	12	1500	50	80103
K 8 x 8	M 8 F	M 8 F	58	8	30	9	10	12	2500	50	80104
K 12 x 12	M 12 F	M 12 F	90	8	30	13	19	24	5000	50	80105
KS 8 x 6	M 8 M	M 6 F	63	8	30	15	10	12	1500	50	80110
KS 8 x 8	M 8 M	M 8 F	63	8	30	15	10	12	2500	50	80111
KS 10 x 10	M 10 M	M 10 F	64	8	30	15	13	13	2500	50	80106
KK 8 x 8	M 8 M	M 8 F	46	8	29	15	10	-	2500	50	80107
KK 10 x 10	M 10 M	M 10 F	47	8	30.5	15	13	-	2500	50	80108

EYE BOLTS

EB Eye Bolts

Forged cast iron, zinc-plated.

Type	Connection		Order Code
EB 25 - 8	M 8	250	33267



Eye Bolts

Type	Version	Connection thread		Order Code
Copper screw eye	Copper	M 6 x 24	100	52808
Promat zinc-plated screw eyes	promat zinc-plated	M 6 x 24	100	52804
Chrome/nickel alloy screw eyes	Chrome/nickel alloy	M 6 x 24	100	52806



EB-LB Eye Bolts

For easy mounting of LB mounting strip to the ceiling.

- Electrolytically zinc-plated.
- EB 6 x 25 recommended for LB 17 and LB 19.
- EB 8 x 20 recommended for LB 27.



Type	Characteristics	Connection		Order Code
EB 6 x 25	Screw thread and slotted hole	M 6 x 25	100	71024
EB 6 x 50	Wood screw thread and slotted hole	M 6 x 50	100	71023
EB 8 x 20	Screw thread and round hole	M 8 x 20	100	71027

BACKPLATES

For a rigid wall or ceiling fastening of a clip by means of a threaded rod/pipe.

- Electrolytically zinc-plated.
- Slotted holes for fixing.
- Can also be used in fixed point constructions, in combination with KB clips or BVP bracket, fixed point.

GP Backplates Ø 60

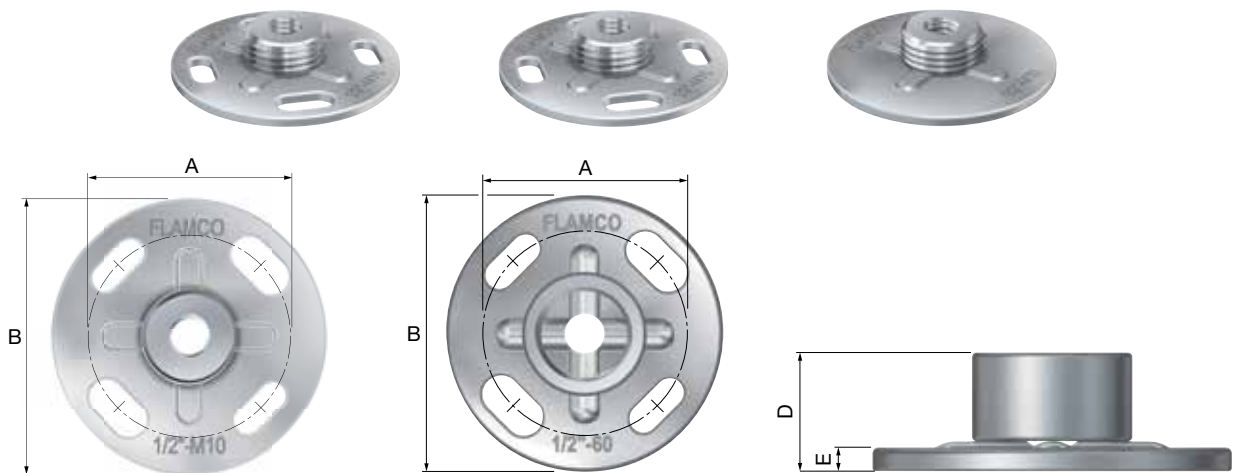

Type	Connection	Dimensions				Slotted hole [mm]		Order Code
		A [mm]	B [mm]	D [mm]	E [mm]			
GP 1/2 - 60	1/2" F	44	Ø 60	18	3	15 x 8 / 14 x 6	50	39416
GP round with slotted hole	1/2" M / M 10 F	44	Ø 60	13	3	15 x 8 / 14 x 6	50	39422
GP round without slotted hole	1/2" M / M 10 F	-	Ø 60	13	3	-	50	39423



GP Backplates 80 x 30

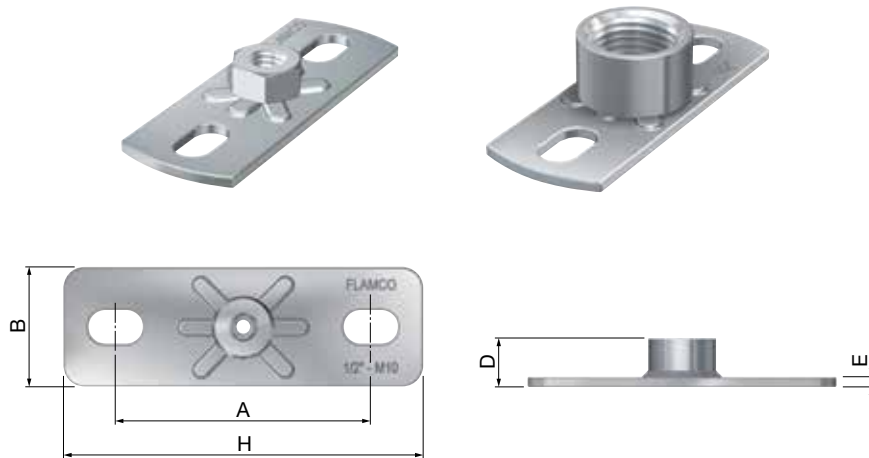

Type	Connection	Dimensions						Slotted hole [mm]	Order Code
		A [mm]	B [mm]	H [mm]	D [mm]	E [mm]			
SR2-L - R 3/8"	R 3/8"	54	30	80	15	3	9 x 16	50	39440
GP 8 / 10 - 80 x 30	M 8 / 10	54	30	80	18	3	9 x 16	50	39410
GP 8 - 80 x 30 *	M 8	54	30	80	11	3	9 x 16	50	39417
GP 10 - 80 x 30 *	M 10	54	30	80	13	3	9 x 16	50	39413
GP 12 - 80 x 30	M 12	54	30	80	15	3	9 x 16	50	39415
GP 1/2 - 80 x 30 *	1/2" F	54	30	80	18	3	9 x 16	50	39418
GP 1/2 / M 10 - 80 x 30 *	1/2" M / M 10 F	54	30	80	11	3	9 x 16	50	39409

*Also available in stainless steel (Inox V 4 A, 1.4435).

GP-C Backplates 80 x 30

- Safety margin for min. breaking load (V) = 3.

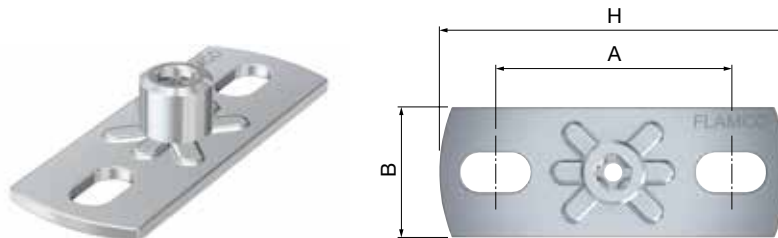

Type	Connection	Max. working load [N]	Max. torque [Ncm]	Dimensions			Order Code	
				A [mm]	B [mm]	H [mm]		
GP-C M 8	M 8	600	1250	54	30	80	50	39400

GP Backplates 120 x 40

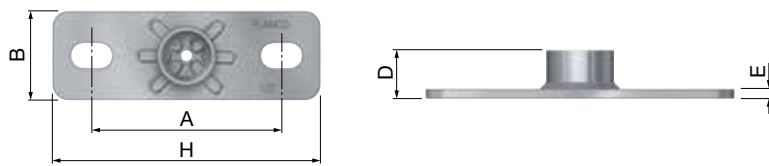

Type	Connection	Dimensions					Slotted hole [mm]		Order Code
		A [mm]	B [mm]	H [mm]	D [mm]	E [mm]			
GP 8 - 120 x 40	M 8	85	40	120	12	4	11 x 18	50	39432
GP 10 - 120 x 40	M 10	85	40	120	14	4	11 x 18	50	39433
GP 1/2 / M 10 - 120 x 40	1/2" M / M 10 F	85	40	120	12	4	11 x 18	50	39442
GP 12 - 120 x 40	M 12	85	40	120	16	4	11 x 18	50	39434
SRG 2 - 3/8	3/8" F	85	40	120	16	4	11 x 18	50	39430
GP 1/2 - 120 x 40	1/2" F	85	40	120	19	4	11 x 18	50	39419
GP 3/4 - 120 x 40	3/4" F	85	40	120	19	4	11 x 18	50	39411
GP 1 - 120 x 40	1" F	85	40	120	25	4	11 x 18	50	39412

GPS Backplates 120 x 40

- Welded all around.

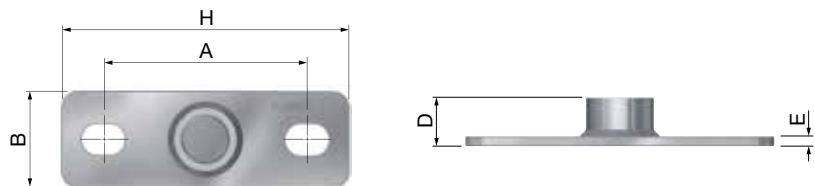

Type	Connection	Dimensions					Slotted hole [mm]		Order Code
		A [mm]	B [mm]	H [mm]	D [mm]	E [mm]			
GPS - 3/8	G 3/8" F	85	40	120	16	4	13 x 18	50	39436
GPS - 1/2	G 1/2" F	85	40	120	19	4	13 x 18	50	39437
GPS - 3/4	G 3/4" F	85	40	120	21	4	13 x 18	50	39438
GPS - 1	G 1" F	85	40	120	25	4	13 x 18	50	39439



GPK Backplates 80 x 30

Copper.
With insert M 10 connection.

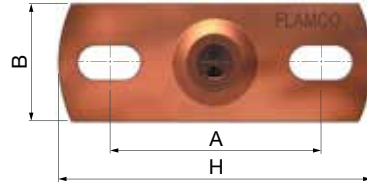
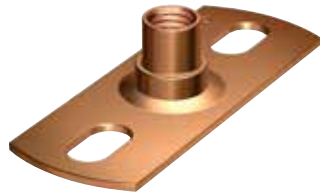

Type	Connection	Dimensions					Slotted hole [mm]		Order Code
		A [mm]	B [mm]	H [mm]	D [mm]	E [mm]			
GPK 10 - 80 x 30	M 10	54	30	80	19	3	9 x 16	50	39444

EXPANSION UNITS

The expansion units are specially designed to allow for thermal expansion along the length of the pipe. This makes for a superb and solid joint which if necessary can move with the pipe.

GK 50 Expansion Units

- Sliding block: nylon PA 6.
- Threaded connection: brass.
- Suitable for any type of Flamco rail.
- Maximum axial movement depends on rail length.

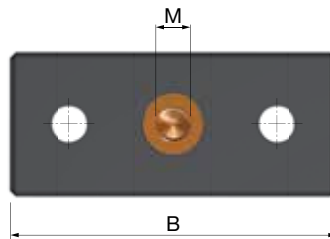

Type	Connection (M)	Dimensions				Max. working load [N]		Order Code
		B [mm]	C [mm]	D [mm]	E [mm]			
GK 50 - M 8	M 8	55	24	11	3.4	500	50	71722

GK 150 Expansion Units

- Backplate S235JR EN 10250/2: electrolytically zinc-plated.
- Carriage holder: nylon PA 6.
- Tube S235JR EN 10250/2: electrolytically zinc-plated.
- Plate stop: plastic.
- Standard axial movement 60 mm.
- Enlarged axial movement when Flamco rail R 2 is used instead of pipe.
- Slotted holes for accurate adjustment of the expansion unit.
- Suitable for different threaded connections.

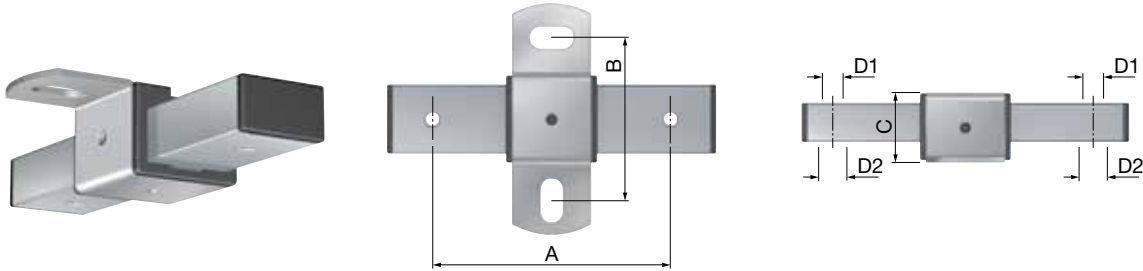

Type	Connection		Dimensions					Max. working load [N]		Order Code
	D1	D2	A [mm]	B [mm]	C [mm]	Ground plate [mm]	Slotted hole [mm]			
GK 150 - M 8/10	M 8	M 10	120	82	35	117 x 140	11 x 22	1500	10	71724

GK 500 Expansion Units

- Carriage holder S235JR EN 10250/2: electrolytically zinc-plated.
- Sliding block: nylon PA 6.
- Pressure plate S235JR EN 10250/2: electrolytically zinc-plated.
- Maximum axial movement 90 mm.
- Pressure plate completely enclosed in sliding block.
- Slotted holes for accurate adjustment of the expansion unit.

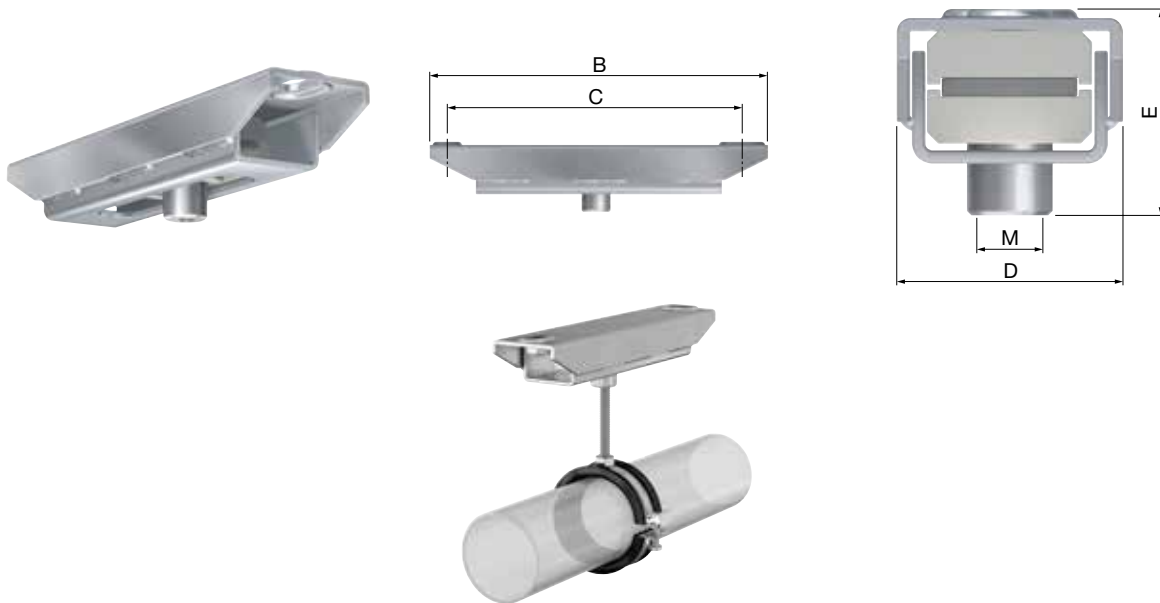

Type	Connection (M)	Dimensions					Max. working load [N]		Order Code
		B [mm]	C [mm]	D [mm]	E [mm]	Slotted hole [mm]			
GK 500 - M 10	M 10	220	195	50	45	11 x 22	5000	10	71714
GK 500 - M 12	M 12	220	195	50	45	11 x 22	5000	10	71716

PROFILE FIXINGS

For fixing a single suspension under a steel profile, without the need for drilling or welding. They are available in different threaded connections and some versions may be adjusted vertically after fixing.

KC Profile Clamps

For securing a single mounting next to or under a steel profile without welding or drilling.

- Forged steel C 22/C 35 - DIN 17200.
- Bolt: steel DIN 564-8.8.
- Electrolytically zinc-plated.

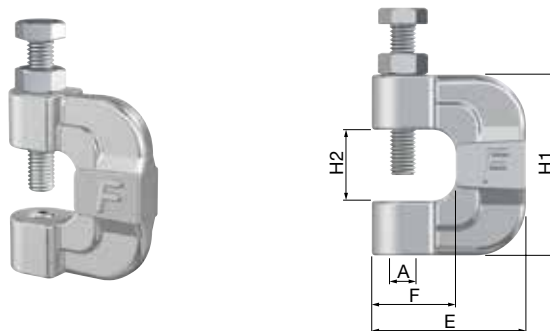

Type	Con- nection A	Max flange thickness [mm]	Bolt	Max. working load [N]	Dimensions				Approval		Order Code
					H1 [mm]	H2 [mm]	E [mm]	F [mm]			
KC 6	M 6	18	M 8 x 45	2100	54	21	46	25	-	25	71521
KC 8	M 8	18	M 8 x 45	3800	54	21	46	25	VdS *	25	71522
KC 10	M 10	18	M 10 x 45	5000	54	21	46	25	FM/ VdS *	25	71523
KC 12	M 12	18	M 10 x 45	5000	54	21	46	25	FM/ VdS *	25	71524

* See VdS certificate (on website) for specific VdS validity. AS anchor strip (71700) may be required.



KCK Profile Clamps

For securing a single mounting next to or under a steel profile without welding or drilling.

- Malleable cast iron, KCK GTS 45 - DIN 1692.
- Steel bolt: steel DIN 564-8.8.
- Electrolytically zinc-plated.
- Vertically adjustable.
- The bottom provided with two different threaded connections.

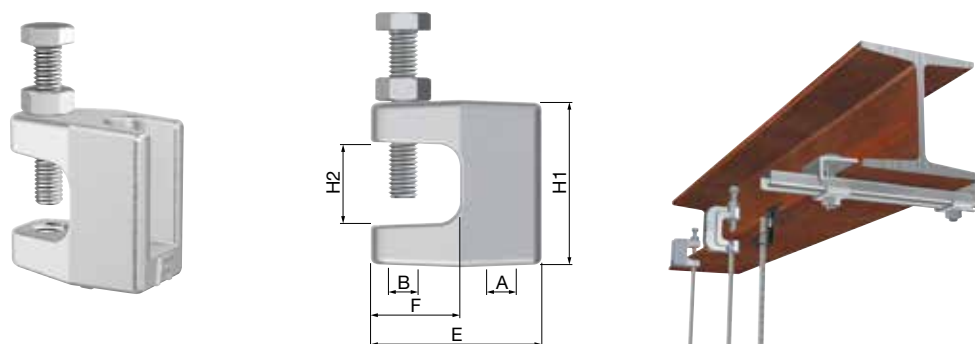

Type	Connection (A - B)	Max flange thickness [mm]	Bolt	Max. working load [N]	Dimensions				Approval		Order Code
					H1 [mm]	H2 [mm]	E [mm]	F [mm]			
KCK 6	M 6 - M 8	18	M 6 x 35	2100	45	21	46	24	-	25	71535
KCK 8	M 8 - M 10	18	M 8 x 45	3800	45	21	46	24	VdS *	25	71536
KCK 10	M 10 - M 8	18	M 10 x 45	4500	45	21	46	24	FM/VdS *	25	71537
KCK 12	M 12 - M 12	18	M 10 x 45	5000	45	21	46	24	FM/VdS *	25	71538

* See VdS certificate (on website) for specific VdS validity. AS anchor strip (71700) may be required.



KCH Profile Clamps

For securing a single mounting next to or under a steel profile without welding or drilling.

- Forged steel C 22/C 35 - DIN 17200.
- Bolt: steel DIN 564-8.8.
- Electrolytically zinc-plated.

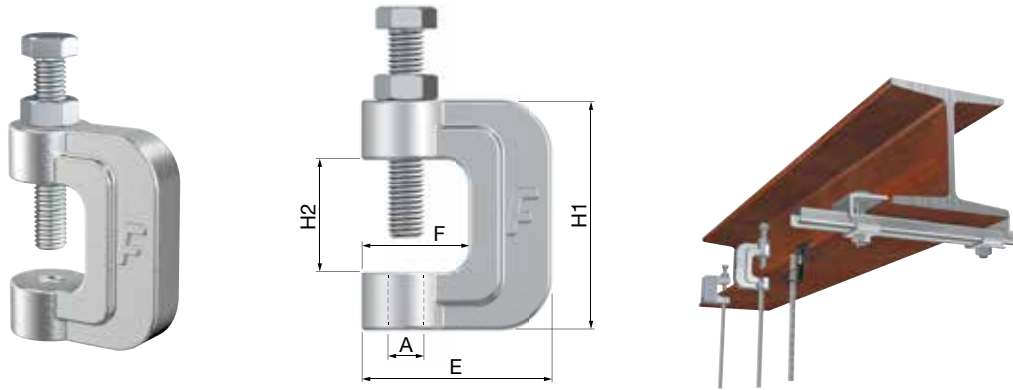

Type	Connection (A)	Max. flange thickness [mm]	Bolt	Max. working load [N]	Dimensions				Approval		Order Code
					H1 [mm]	H2 [mm]	E [mm]	F [mm]			
KCH 8	M 8	30	M 10 x 60	3800	65	32	54	30	VdS *	25	71541
KCH 10	M 10	30	M 10 x 60	6000	65	32	54	30	VdS *	25	71542
KCH 12	M 12	30	M 12 x 60	6000	65	32	54	30	VdS *	25	71543
KCH 16	M 16	30	M 12 x 60	6000	65	32	54	30	-	25	71544

* See VdS certificate (on website) for specific VdS validity. AS anchor strip (71700) may be required.



KCL Profile Clamps

For securing a single mounting next to or under a steel profile without welding or drilling.

- Malleable cast iron, KCL GTS 35 - DIN 1692.
- Steel bolt: steel DIN 564-8.8.
- Electrolytically zinc-plated.
- Vertically adjustable.
- The bottom is provided with two different threaded connections.

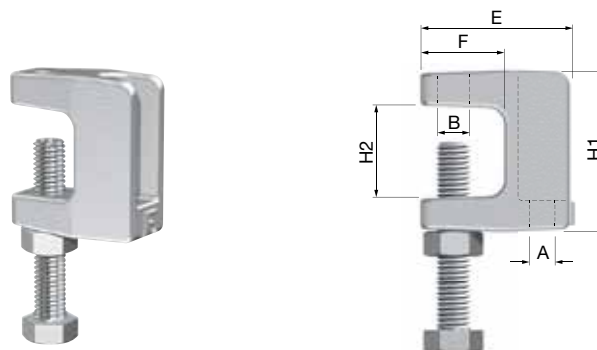

Type	Connection		Max flange thickness [mm]	Bolt	Max. working load [N]	Dimensions					Order Code
	A [mm]	B [mm]				H1 [mm]	H2 [mm]	E [mm]	F [mm]		
KCL 6	M 6	M 6	18	M 6 x 35	2100	39	21	36	20	25	71570
KCL 8	M 8	M 8	18	M 8 x 45	2500	39	21	36	20	25	71571

KVS-D Profile Clamps

For mounting a suspension to a steel profile without drilling or welding.

- Black spring steel.
- Hinged fixture.
- Vertically adjustable.
- Fast assembly with a hammer.

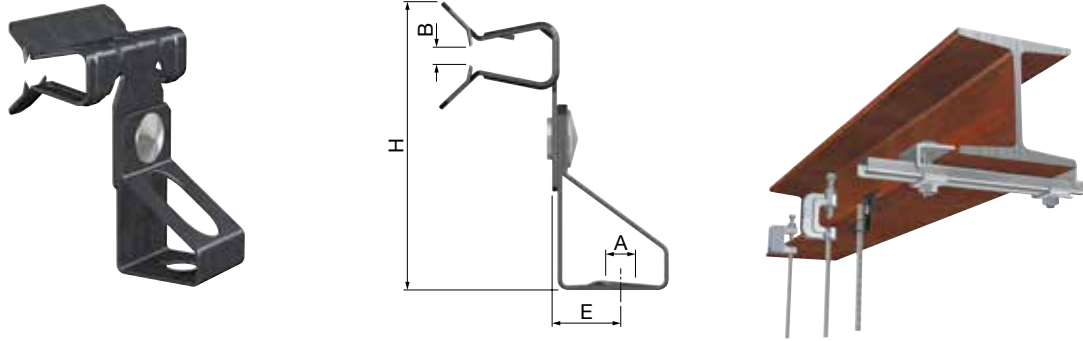

Type	Connection (A)	Flange thickness B [mm]	Dimensions		Max. working load [N]	Treatment		Order Code
			H [mm]	E [mm]				
KVS-D 6 x 4,8 - 9,5	M 6	4,8 x 9,5	50	10	700	Untreated	250	71556
KVS-D 8 x 4,8 - 9,5	M 8	4,8 x 9,5	50	10	700	Untreated	250	71557

BC Profile Clamps

For securing a single mounting next to or under a steel profile without welding or drilling.

- Malleable cast iron.
- Electrolytically zinc-plated.

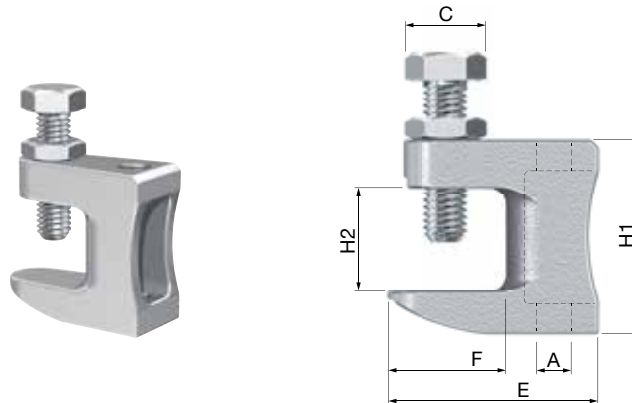

Type	Connection A [mm]	Bolt (C)	Max. working load [N]	Dimensions				Approval		Order Code
				H1 [mm]	H2 [mm]	E [mm]	F [mm]			
BC 8	M 8	M 8 x 30	1200	37	18	38	21	VdS *	50	71506
BC 10	M 10	M 10 x 40	2500	42	19	44	23	VdS * / FM	50	71507
BC 12	M 12	M 10 x 40	3500	54	25	58	35	VdS * / FM	50	71508
BC 9	Ø 9	M 8 x 30	1200	37	18	38	21	-	50	71510
BC 11	Ø 11	M 10 x 40	2500	42	19	44	23	FM	50	71511

* See VdS certificate (on website) for specific VdS validity. AS anchor strip (71700) may be required.

AS Anchor strips

Anchor strips for use with KC, KCK, KCH and BC profile clamps.
May be required for VdS approval. See VdS certificates (on website) for details.



Type	Suitable for		Order Code
AS 1	BC/KC/KCK/KCH 8/10/12	50	71700

TRAPEZIUM FIXINGS

For mounting threaded rod to steel roof profiles.

- Electrolytically zinc-plated.
- LT : threadless opening.
- LTM: with welded nut.
- LTV: vertical re-adjustment by turning the lowest part of the threaded bush, after mounting the threaded rod.

Trapezium Fixings

- Threaded rod not included.
- Maximum working load: 1.6 kN (for roof profile thickness of 1 mm).

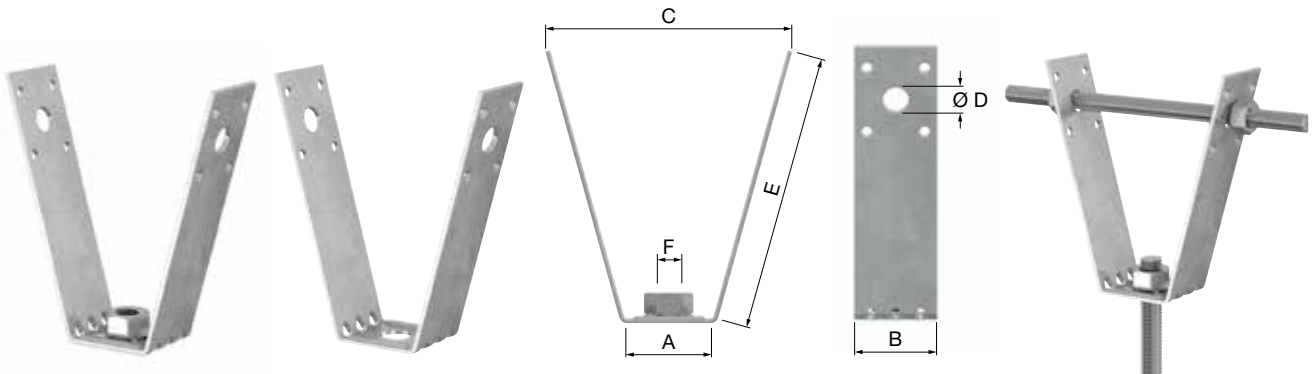

Type	Dimensions					Connection (F)		Order Code
	A [mm]	B [mm]	C [mm]	D [mm]	E [mm]			
LT	32	30	90	10.5	100	Ø 12	10	71900
LTM 8	32	30	90	10.5	100	M 8	10	71910
LTM 10*	32	30	90	10.5	100	M 10	10	71912
LTM 12	32	30	90	10.5	100	M 12	10	71914

* LTM 10 FM approved in combination with clips ranging from ¼" to 3".



Trapezium Pliers

Type		Order Code
PT	1	27929
Spare cutting nipples	1	27939





AIR DUCT BRACKETS

For mounting air ducts.

- Electrolytically zinc-plated.
- Rubber shock absorber at the attachment point of the threaded rod for noise-suppression.

LL Air Duct Bracket

For mounting rectangular air ducts.

- Noise reduction: 18 dB(A) according to ISO 3822-1.

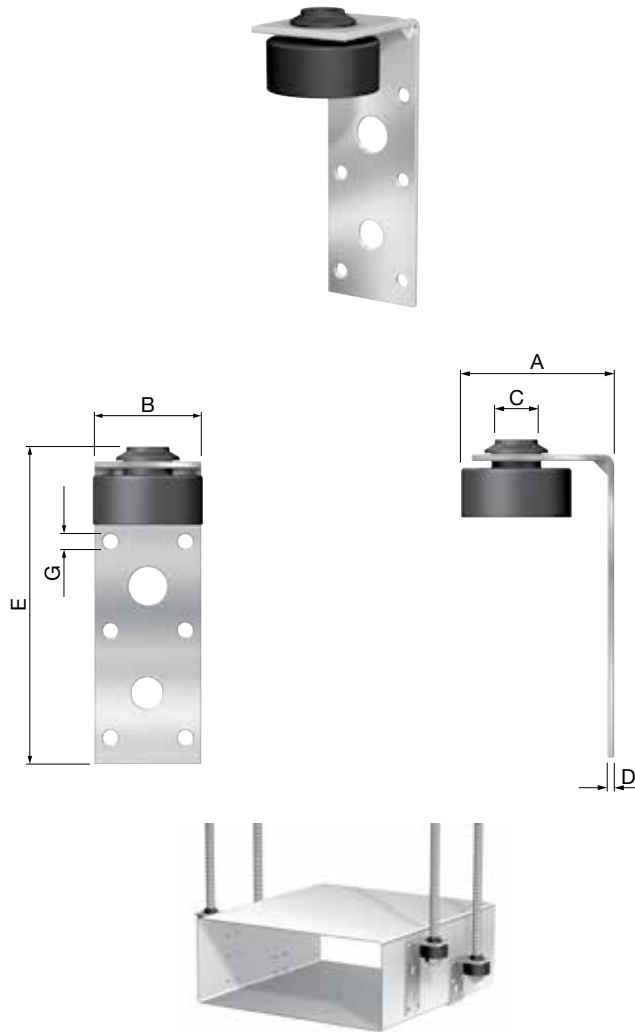

Type	Dimensions							Order Code
	A [mm]	B [mm]	G [mm]	D [mm]	E [mm]	C [mm]		
LL 130	40	30	4.2	2	130	8.5	50	71943

BACKPLATE ASSEMBLIES

For use in combination with Flamco BS universal clips.

- Electrolytically zinc-plated.

BME Backplate Assembly

For double wall clip mounting.

- Rigid pipe installation as a result of fixed centres.
- Relative centres adjustable.

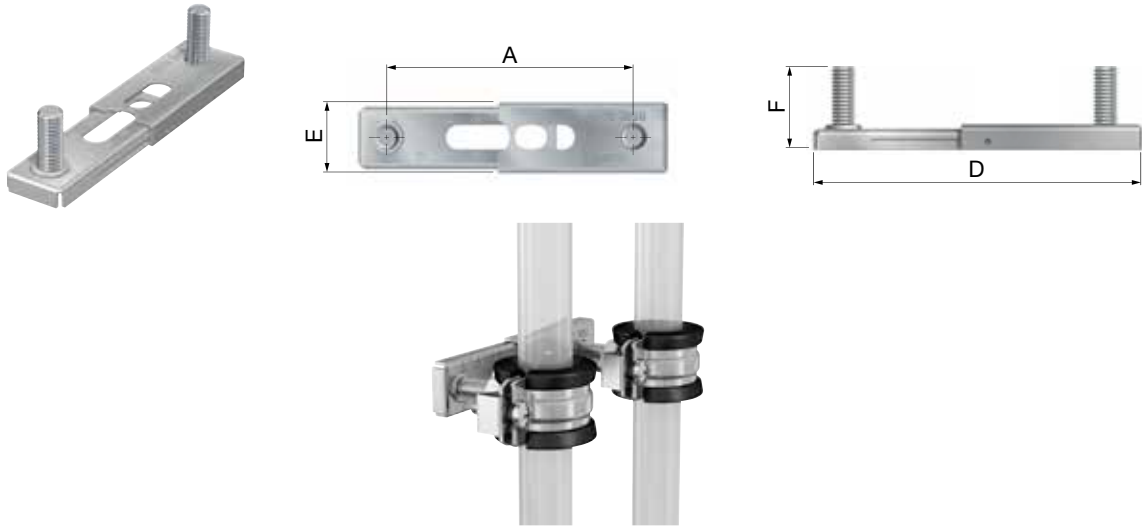

Type	Connection	Dimensions						Order Code
		Ø hole [mm]	A [mm]	D [mm]	E [mm]	F [mm]		
BME 8 x 50/90	M 8	8	50 - 90	72 - 112	25	29	100	39420

BMD Backplate Assemblies

For double wall clip mounting.

- Rigid pipe installation as a result of fixed centres.

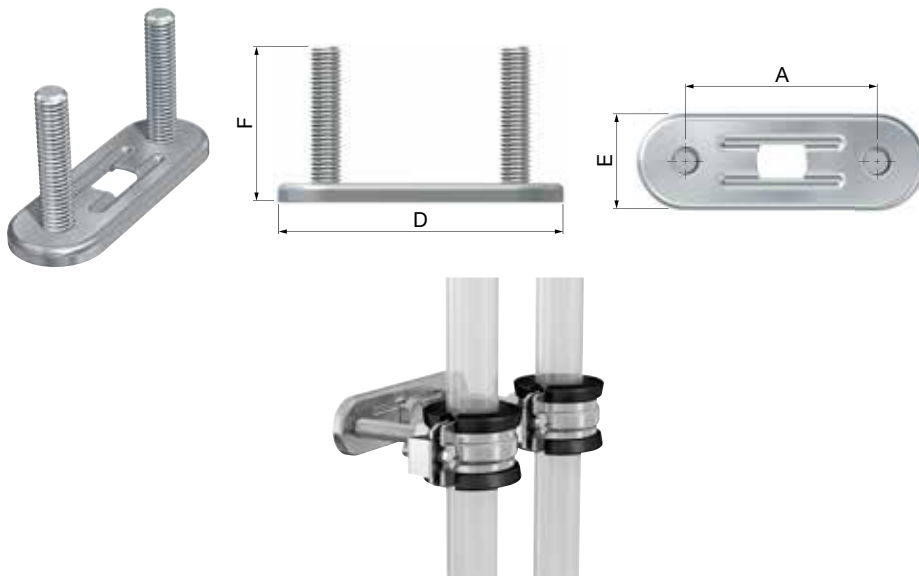

Type	Connection	Dimensions						Order Code
		Ø hole [mm]	A [mm]	D [mm]	E [mm]	F [mm]		
BMD 8 x 50	M 8	8	50	76	25	40	100	39424
BMD 8 x 70	M 8	8	70	96	25	40	100	39426
BMD 8 x 90	M 8	8	90	116	25	40	100	39428



BMF Backplate Assemblies

For use with two wall clips.

- Slotted hole for fixing.
- Threaded connections M 8 for DS threaded nipples.
- In combination with DS threaded nipples, suitable for BS universal clips.
- Realisation of two different centres to the wall per backplate assembly possible.

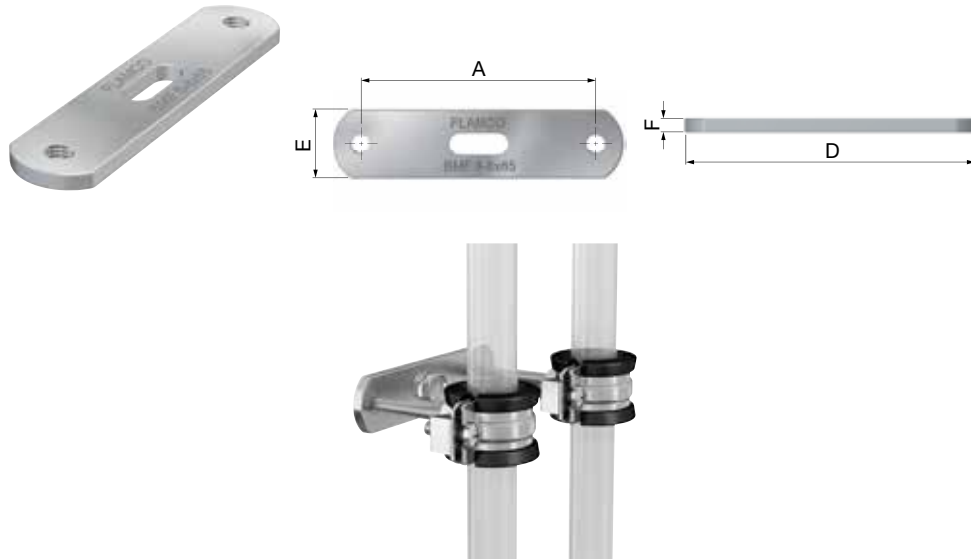

Type	Connection	Slotted hole [mm]	Dimensions					Order Code
			A [mm]	D [mm]	E [mm]	F [mm]		
BMF 8 - 8 x 65	M 8	8.2 x 22	65	85	25	5	50	37952
BMF 8 - 8 x 85	M 8	8.2 x 22	85	105	25	5	50	37953
BMF 8 - 8 x 105	M 8	8.2 x 22	105	125	25	5	50	37954
BMF 8 - 8 x 150	M 8	8.2 x 22	150	170	25	5	50	37955
BMF 8 - 8 x 200	M 8	8.2 x 22	200	220	25	5	50	37956

FIXED POINT CONSTRUCTIONS

VG Angle Plate

For making a fixed point construction, adjustable suspension or support construction.

- Electrolytically zinc-plated.
- Supplied with slotted holes.
- Sleeves suitable for M 10.
- Specially suited for fixed point constructions in combination with BSP fixed point clips.

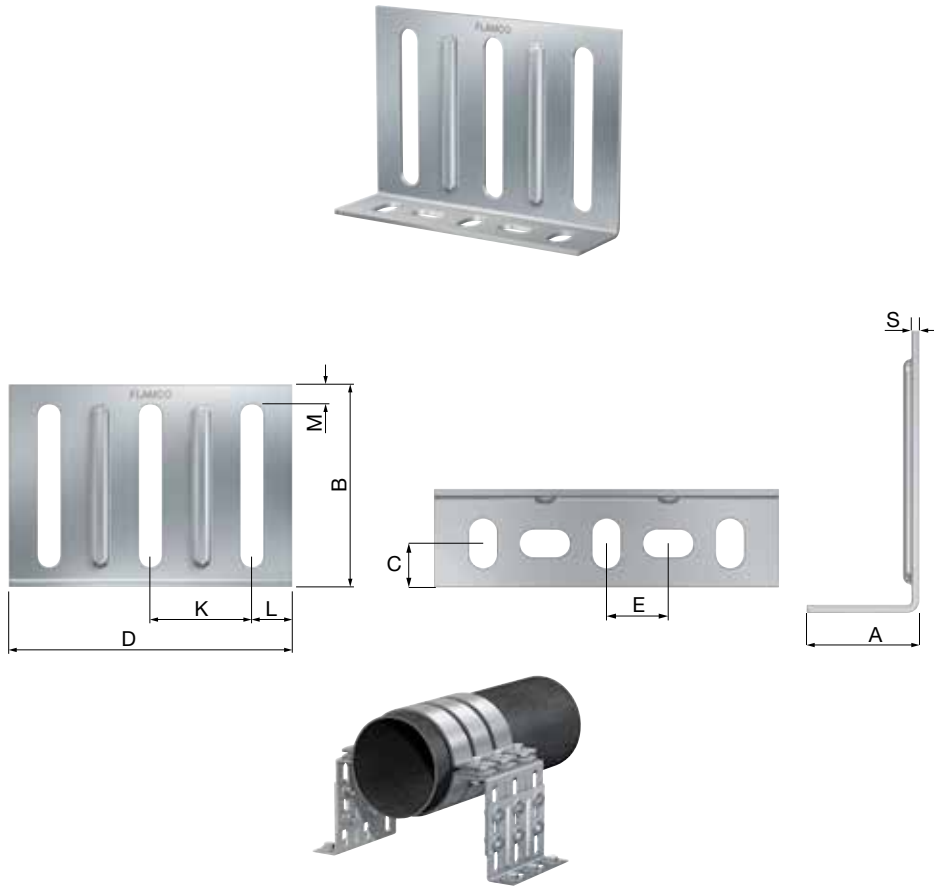

Type	Dimensions										Order Code
	A [mm]	B [mm]	C [mm]	D [mm]	E [mm]	K [mm]	L [mm]	M [mm]	S [mm]		
VG 140 x 100 x 3	40	100	18.5	140	25	50	11	10	3	10	71616



BVP Fixed Point Construction Set

- Consisting of 2x BVP-1, 2x BVP-D en 2x GP 10 120 x 40.
- Electrolytically zinc-plated.



BVP 135-1

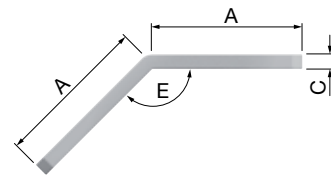
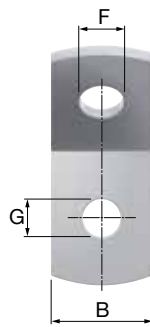

BVP 135-D

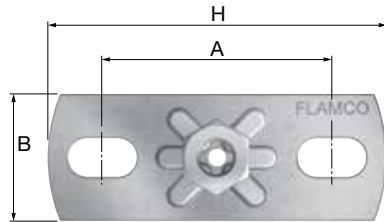
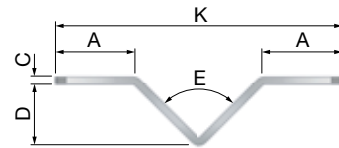
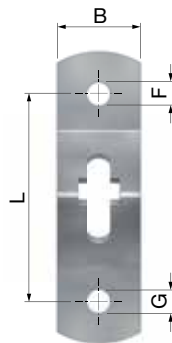

Type

BVP Fixed Point Construction Set



10

Order Code

71629

NOISE-SUPPRESSION FIXTURES

For a noise reducing suspension.

DA Noise-suppression Fixtures

- Housing: electrolytically zinc-plated.
- Noise suppression: 20 dB(A), see TNO-TH 807/410/1 report.
- Suitable for temperatures of -50 °C up to +110 °C.
- Hardness of rubber: 65 - 70 ° Shore A.

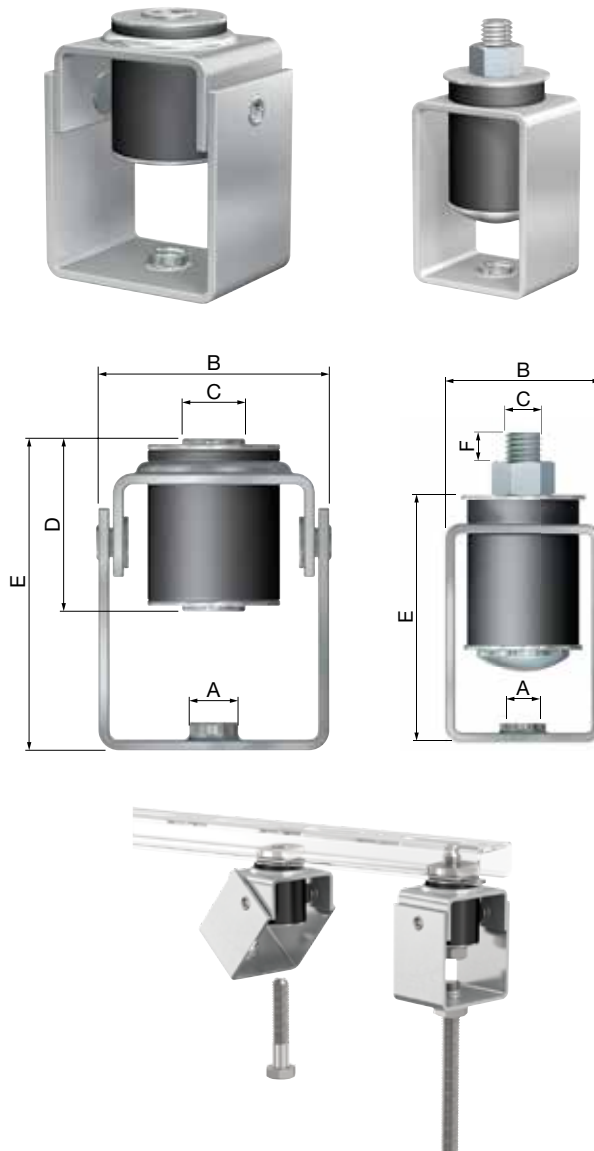

Type	Dimensions						Max. working load [N] *		Order Code
	A [mm]	B [mm]	C [mm]	D [mm]	E [mm]	F [mm]			
DA 6	M 6	Ø 40 x 30	Ø 8.5	32	55	-	500	50	80800
DA 8	M 8	Ø 40 x 30	Ø 8.5	32	55	-	500	50	80801
DA 12	M 12	Ø 50 x 40	M 12	-	99	21	2000	50	80802

* At 20 dB(A) noise reduction.