



Flamco

Ausführungen und Abmessungen GP / SRG Befestigungsplatten Ø 60

Typ	Gewinde-anschluss	Masse in mm					Langloch	Artikel-Nr.
		A	B	H	D	E		
GP 1/2 / M 10 - Ø 60	1/2" / M 10	44	Ø 60	-	11	3	16 x 6 / 15 x 8	5392.71
GP 1/2 / M 10 - Ø 60	1/2" / M 10	-	Ø 60	-	11	3	-	5392.70
GP 1/2 - 60	1/2"	44	Ø 60	-	18	3	16 x 6 / 15 x 8	39416
GP 3/4 - 60	3/4"	50	Ø 60	60	21	4	Ø 6,5	39414
SRG 1 - 3/8	3/8"	-	-	-	-	-	-	5392.51
SRG 1 - 1/2	1/2"	44	-	-	18	3	-	5392.52
SRG 1 - 3/4	3/4"	-	-	-	-	-	-	5392.53
SRG 1 - M 10	M 10	45	-	-	18	3	-	5392.56

GP

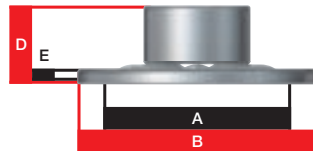

GP 1/2 - M 10



GP 1/2 - 60

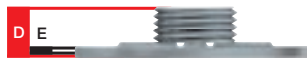
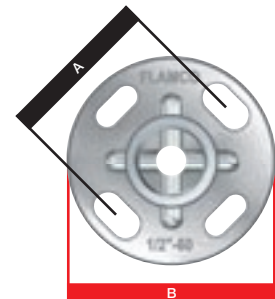

SRG 1

