

# VK 31 Euro Taper Base Board Connection Kit

for screw connections to fit 3/4" Euro taper (DIN EN 16313)



Work on heating and domestic water systems must only be done by qualified professional personnel and in accordance with the respective applicable regulations, guidelines and rules of engineering.



## Refer in particular to:

**DIN 18 380:** Heating systems and central hot water heating systems

**VDI 2035:** Scale formation in water heating systems

**BGV:** German Professional Association Regulations (accident prevention regulations)

*(DIN = The German Institute for Standardisation*

*VDI = Association of German Engineers)*



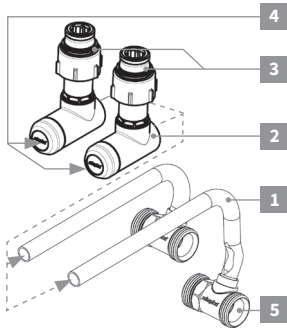
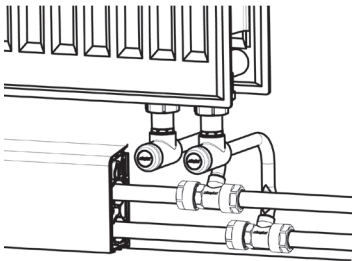

## Assembling the Connection Kit

**Important! Absolute adherence to the assembly sequence!**

- When installing the VK 31 Euro Taper Base Board Connection Kit (3/4" Euro taper), **always assemble the return flow first** according to the following steps. Only commence work on the supply flow once the return flow has been installed.
- 1 After assembling the radiator, cut to appropriate length and de-burr the connection pipes of the telescopic angle valve.
- 2 Push the telescopic angle valve onto the connection pipe of the radiator.
- 3 Screw the union nut onto the radiator and tighten it with a spanner wrench 30 mm (use connection nipples for radiators with 1/2" female thread, cone inserts for radiators with 3/4" male thread).

- 4 Remove the protective cap and tighten the compression adapter, integrated in the telescopic angle valve, at the front by utilising a spanner wrench 13 mm.

**Important!**

Only utilise the valve spindle with Allen key 4 mm for shutting-off the radiator after completion of the installation work.

An incorrect sequence will cause irreparable damage to the spindle and malfunction!

- Measure the pipes udes for the installation and cut it at right angles. Work as precisely as possible here, as the pipe length affects the ease of installation and the axial distance between the connection kit supply flow and return flow connection on the radiator side.

Take into account the installation instructions for the respective type of screw connection. Use a hexagonal spanner wrench to provide resistance.

**Caution:** The socket depth for pipes is not limited by the valve. Make sure that a sufficient gap of approx. 1 cm is maintained between the left and right end of the pipe when using screw connections without limited pipe socket depth.

Otherwise, the required supply to the connected radiator cannot be guaranteed under certain circumstances.

- Remove the valve from the radiator again.
- 5 De-burr and calibrate the cut pipes and connect flush with the threaded connection of the valve.
- Screw a suitable compression adapter to the threaded connection and fit to the radiator.

- With several radiators on one wall, always assemble the complete connection of the return flow firstly.
- Then fit the supply flow (in the same way as the return flow).

## **Shutting-off the Radiator**

- Remove the protective cap and shut-off the telescopic angle valve at the front by utilising an Allen Key 4 mm in a clockwise direction.

### **Important:**

**Shut-off the valve spindle (wrench size 4 mm) only after fully tightening (clockwise) the integrated compression adapter (wrench size 13 mm).**

## **Dismantling the Connection Kit with 3/4“ Euro Taper**

- Use an appropriate wrench to loosen the compression adapter. Use a hexagonal spanner wrench to provide resistance.

## Dimensional Drawings

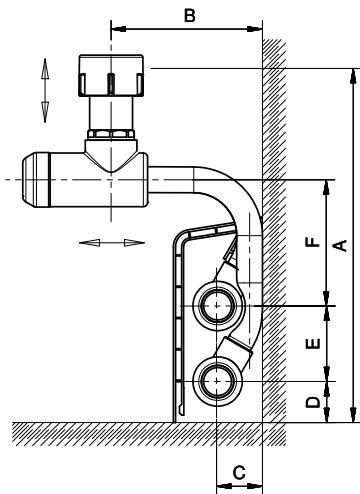
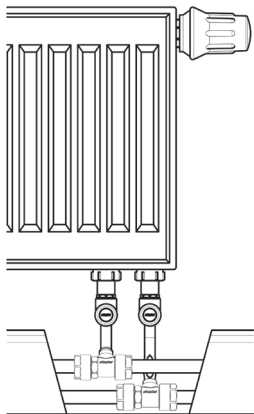

For radiator with integrated valve with	A*		B*		C	D	E	F
	min.	max.	min.	max.				
Rp 1/2	175	200	50	175	21.5	19	35	59
G 3/4 male	164	189	50	175				

\* up to radiator connection (data in mm)

## Installation Length (Z-dimension)

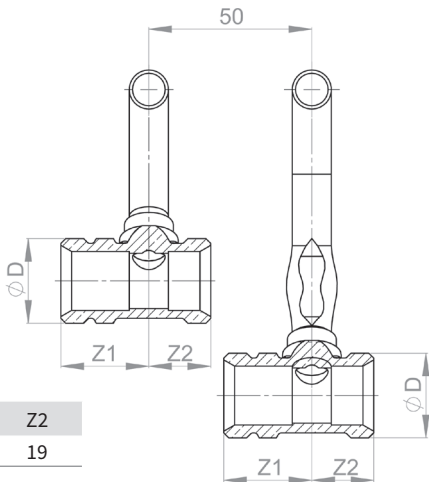

$\varnothing D$	Z1	Z2
3/4" Euro taper	27	19

(Dimensions in mm)

Pay attention to the respective connection dimension (Z-dimension) of the pipe connector used!

The illustrations are symbolic and may differ from the respective product.  
Errors and technical changes reserved.

01/2017