

Warnings

Check the controller and its packaging carefully. If you see visible damage to the controller, do not use it. Installing a damaged product can be life-threatening.

When adjusting the controller, pay attention to the correct opening direction of the valve. Wrong turning direction can lead to high or low temperatures in the system and consequently damage to the system.

When adjusting the controller, make sure you set the minimum and maximum value of requested temperatures correctly. Incorrectly selected limit values for setting the requested temperature lead to a wrong setup of requested temperature and, consequently, undesirable operation and/or damage to the system and user.

The fixed value controller is designed to control a mixer. Any other use is not intended. The controller may only be installed and operated in:

- Dry, non-explosive environment.
- Enclosed rooms.
- Rooms with a temperature between 0 °C and +55 °C.

Every project with controller must have independent system protection for cases of too low or too high temperatures. The controller does not perform protection functions for cases of too high or too low temperatures in the system. High or low temperatures in the system can cause damage to the system and user.

Description of the controller

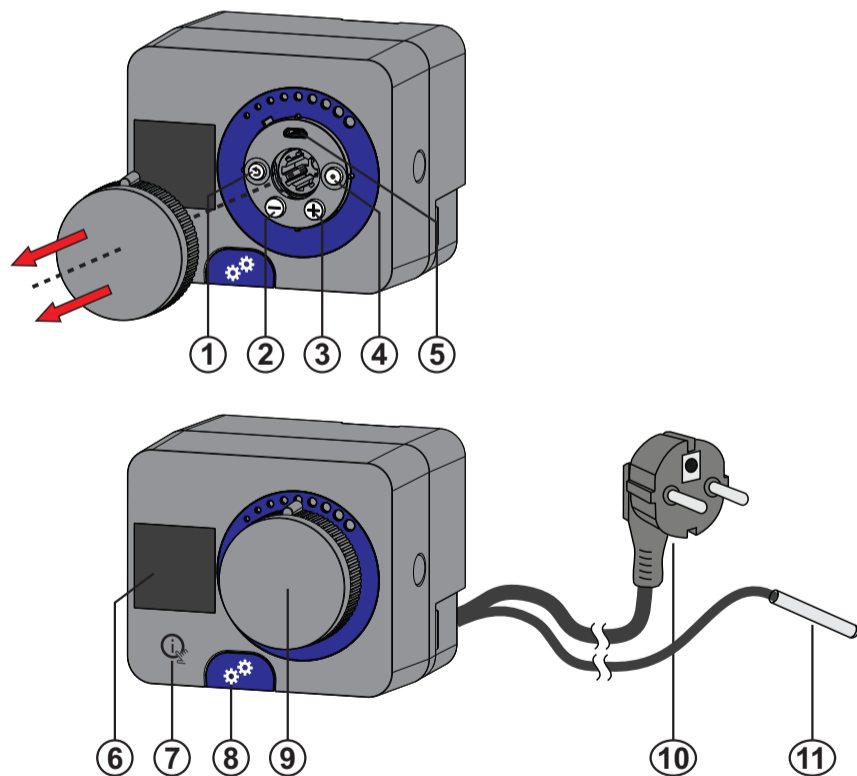

- 1 - Button (Reset).
- 2 - Button (Move to left or decrease value).
- 3 - Button (Move to right or increase value).
- 4 - Button (Confirm selection).
- 5 - USB connection for PC
- 6 - Graphic display.
- 7 - Button (Help / User manual).
- 8 - Clutch for manual operation.
- 9 - Removable knob for manual operation.
- 10 - Pre-wired power cord with plug.
- 11 - Pre-wired temperature sensor.

Commissioning of the controller

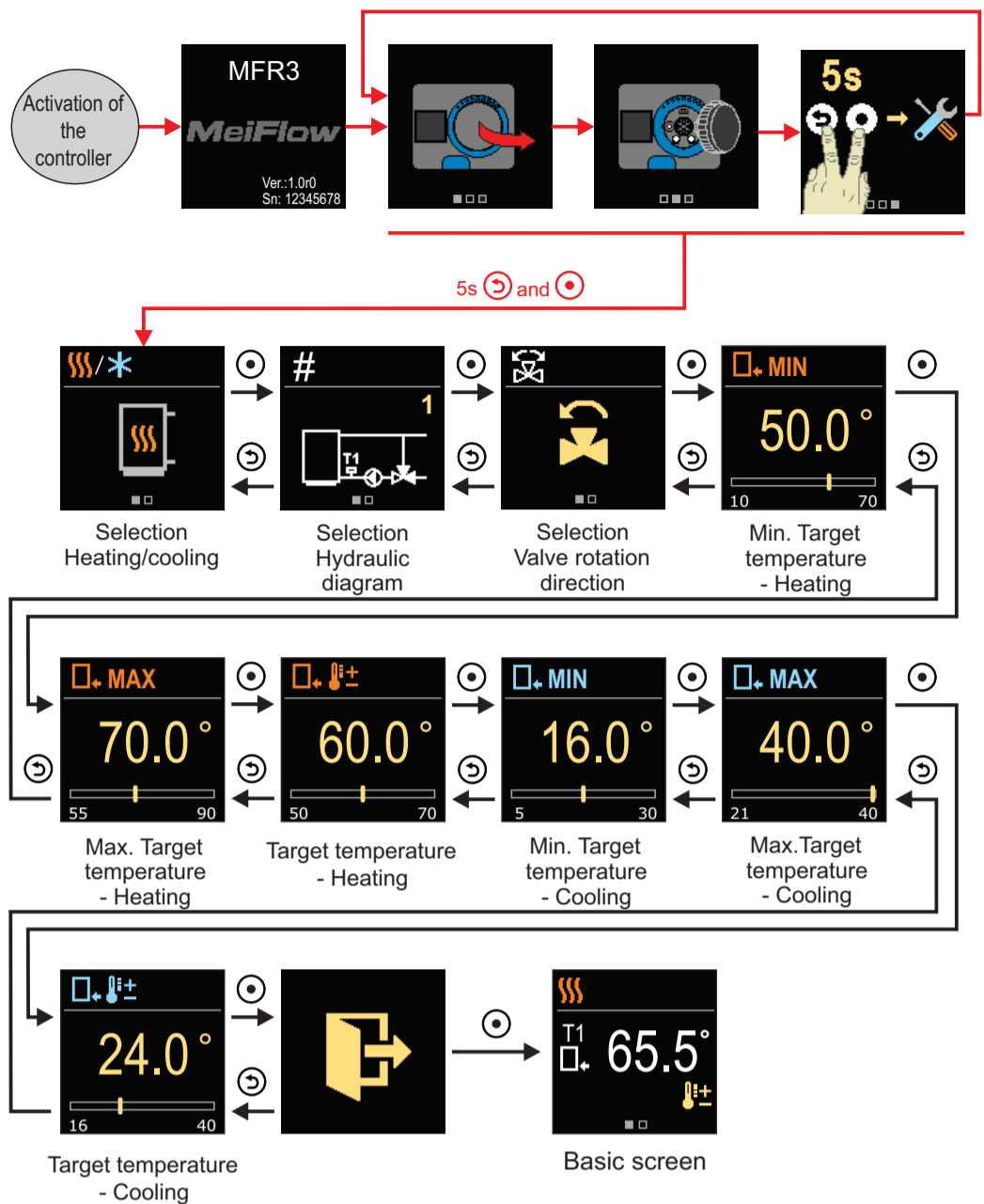

Heating / cooling selection



Hydraulic scheme selection

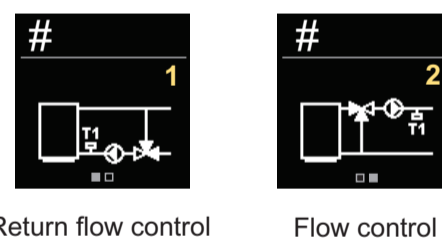

Valve rotation direction

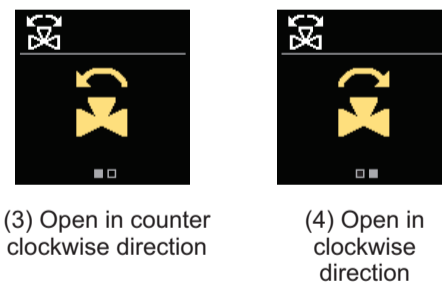

Function	Valve Direction of rotation
Mixer left	3
Mixer right	4 *
Return flow increase TKM	4

* = Factory setting

Minimum, maximum and target temperature when heating

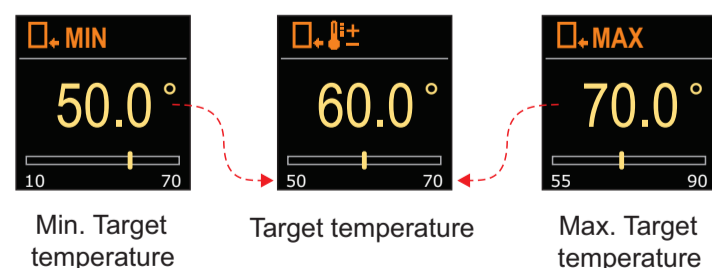

Minimum, maximum and target temperature when cooling

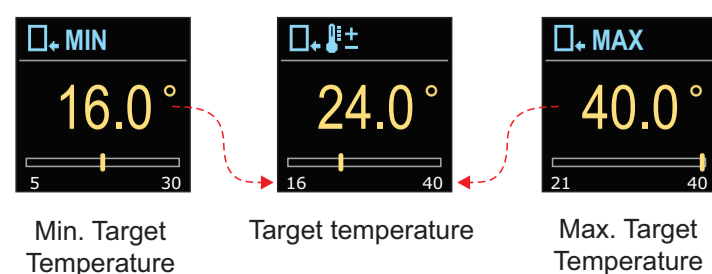

Basic screen



- Type of operation
- Actual temperature
- Target temperature



- Type of operation
- Actual and target temperature
- Hydraulic diagram

Displayed symbols:

- Heating
- Cooling
- Valve rotation direction counter clockwise
- Valve rotation direction clockwise
- Return flow temperature
- Flow temperature
- Transmission deactivated
- Target temperature
- Error

Replacement of the power cord

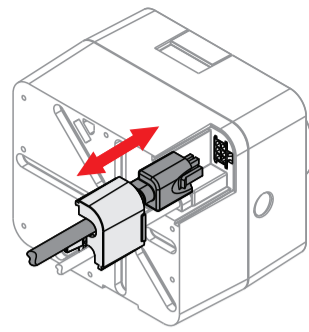

If the power cord is damaged, it can be replaced. The cable is equipped with the mains plug and connector. To replace the cable, the cable protection cover must first be removed.

i The replacement of the power cord is only possible with the original power cord.

! Fatal risk of electric shock! Before starting the installation, always make sure that you are completely disconnected from the mains and secure against being switched on again!

Valve direction setting - shortcut

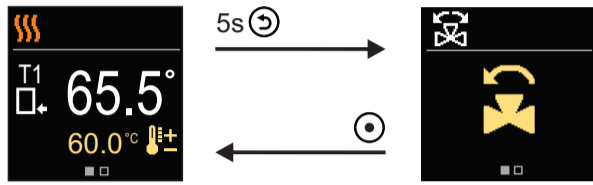

Basic screen

Settings are made with buttons \oplus and \ominus and confirmed with button \odot

User instructions

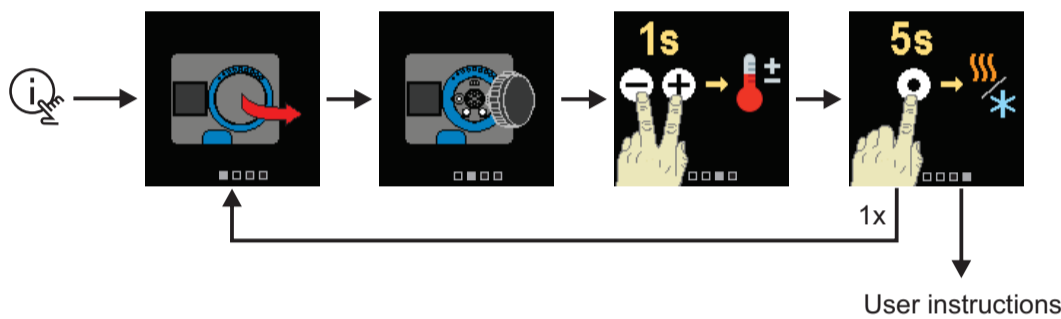

User instructions

Target temperature setting

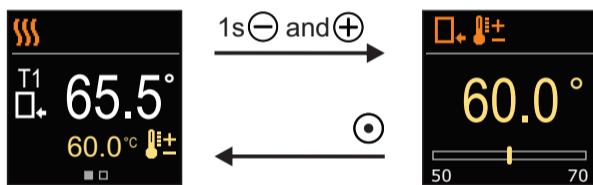

Basic screen

Settings are made with buttons \oplus and \ominus and confirmed with button \odot

Heating / cooling selection

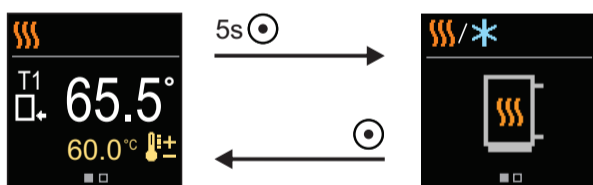

Basic screen

Settings are made with buttons \oplus and \ominus and confirmed with button \odot

Manual operation

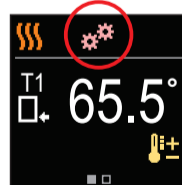
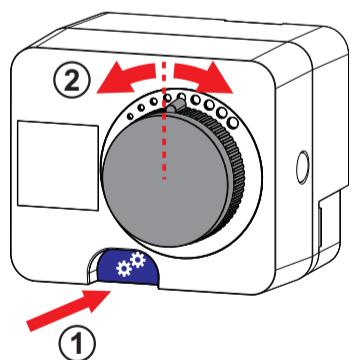

Basic screen

Manual movement of the mixing valve is activated by pressing the clutch button. The desired position of the mixing valve is set by turning the rotary knob. With renewed pressure on the clutch button, manual movement is deactivated.

i When the clutch is activated, the control of the mixing valve switches off.

Error

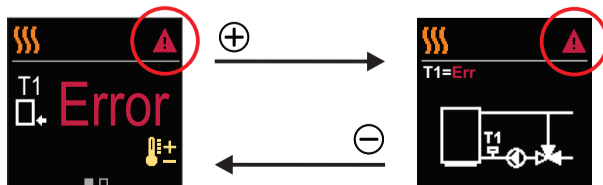

Basic screen

Basic screen

Assembly and electr. connection

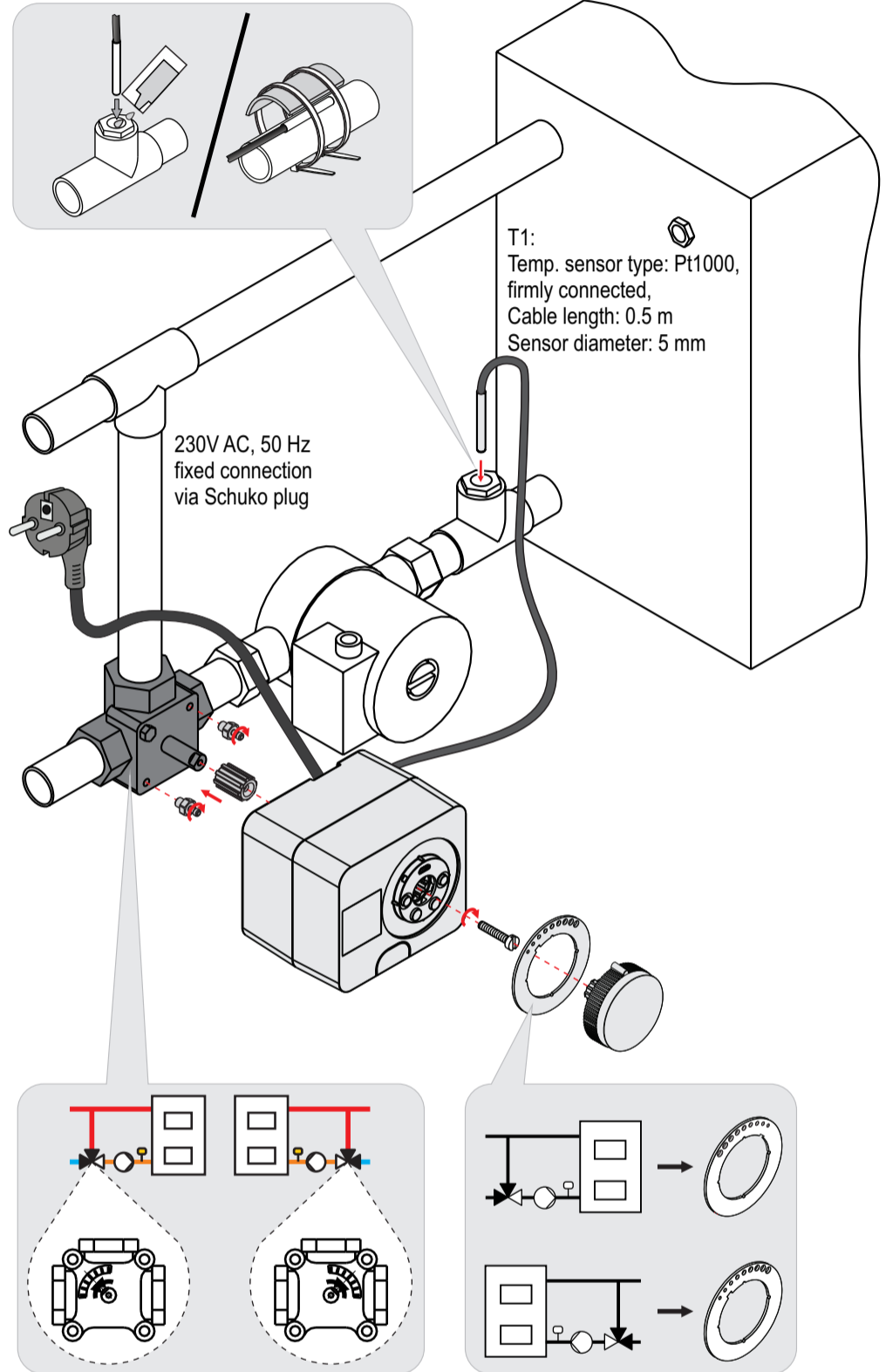

Dimensions

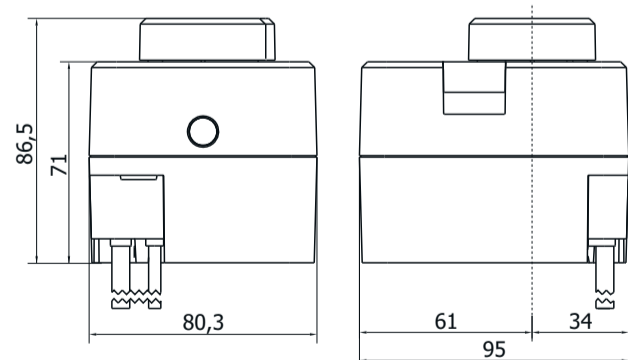

Technical data

Torque:	6 Nm
Rotation angle:	90 °
Rotation speed:	2 min / 90 °
Type of operation:	3-point, PID
Supply voltage:	230V AC, 50 Hz
Max. power consumption:	3.5 VA
Temperature range:	0 + 50 °C
Protection class:	IP42 according to EN 60529
Protection class:	I according to EN 60730-1
Dimensions (W x L x H):	86.5 x 95 x 80.3 mm
Weight:	900 g
Colour / material:	Dark gray / PC
Battery:	CR1025 (Li-Mn) 3V
Clock accuracy:	+/- 1s (24h) at 20 °C